



(810) 775-6343 | (810) 77LODGE



Located at

**3397 S LAPEER RD - METAMORA MI**



P.O. Box 158, Metamora MI 48455

Email

**hello@thelodgeforpamperedpets.com**

Website

**thelodgeforpamperedpets.com**

### CHECK-IN/OUT HOURS

#### Monday - Friday

6:30 AM – 12:00 PM

3:00 PM – 6:00 PM

#### Saturday

7:00 AM – 12:00 PM

3:00 PM – 6:00 PM

#### Sunday

2:00 PM – 6:00 PM

**DROP OFF DAYS AND  
SUNDAYS ARE CHARGED  
AS A DAY OF BOARDING**

**RESERVATIONS** are required for all services to ensure we have appropriate staffing to provide the safest and happiest experience for our pet guests.

**ACCEPTED PAYMENTS** in the form of cash, check and credit card. Rates are for cash or check transactions only.

A fee of 4% will be added to all credit card transactions.

**DEPOSIT** equal to the cost of a one-night stay is required for any stay. Cancellation policy: Refundable deposit with minimum 10 days notice to cancel. Refunds will be made within 30 days.

**MAJOR HOLIDAYS** there is no check-in or check-out.

- New Years Day
- Easter Sunday
- Memorial Day
- Fourth of July
- Labor Day
- Thanksgiving Day
- Christmas Day

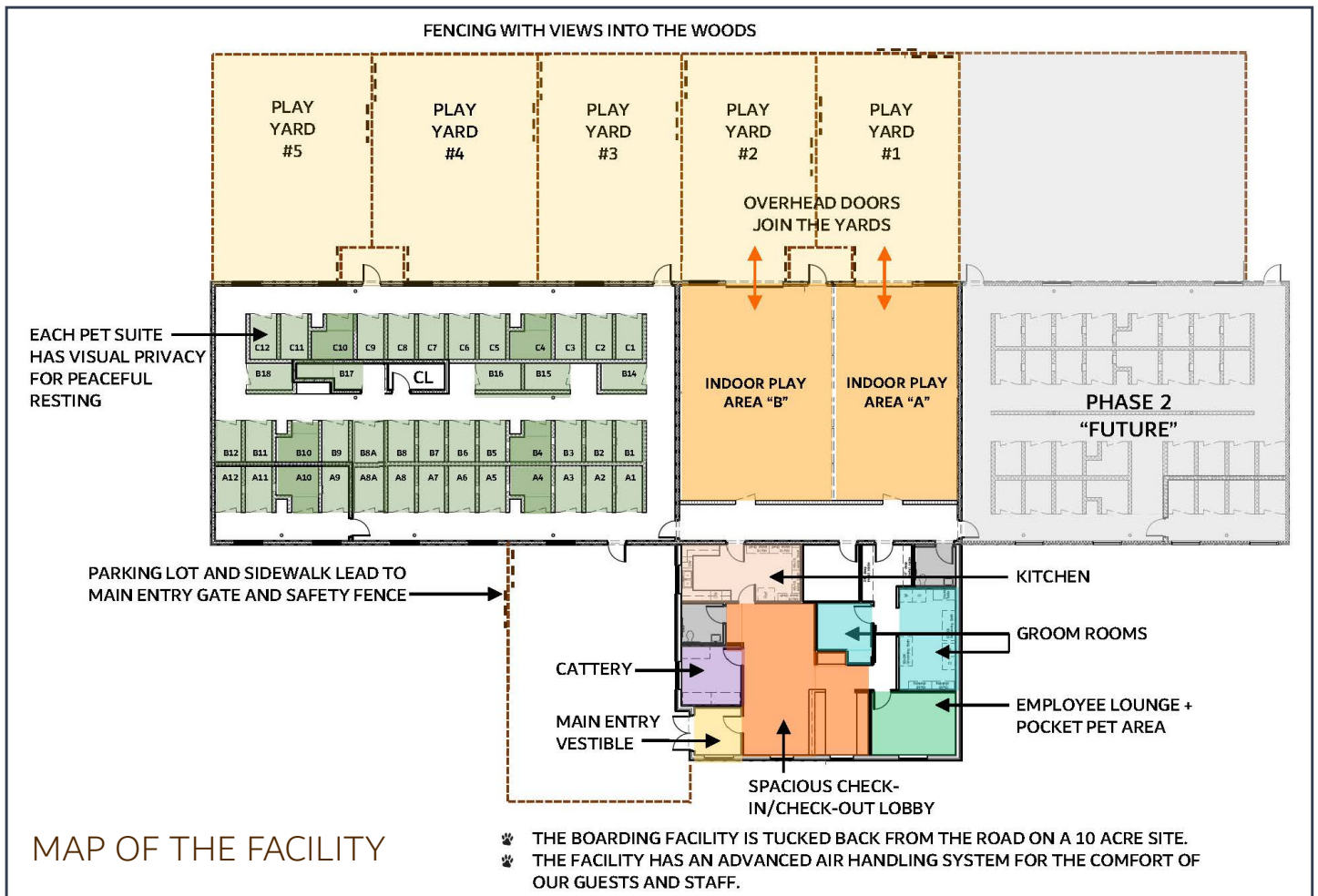

# RATES

## OVERNIGHT STAYS FOR CANINE GUESTS | KENNEL

### STANDARD | 35 SQ. FT.

\$ 45 (1) dog

\$ 85 (2) dogs\*

\$125 (3) dogs\*

### SUITE | 60 SQ. FT.

\$ 50 (1) dog

\$ 90 (2) dogs\*

\$135 (3) dogs\*

For guest families exceeding (3) dogs (call for pricing)

\* Multiple dog pricing is for dogs from the same family who are able to stay together in the same single kennel.

## DAY BOARDING FOR CANINE GUESTS

For guests that cannot play in social daycare settings.

\$28 per dog (6:30A.M.- 6 P.M. Monday-Saturday)

No walk-ins, please call ahead to check kennel availability.

## DAYCARE FOR CANINE GUESTS

\$ 28 per dog full day\*\*

\$ 18 per dog half day (A.M. or P.M.) 4 hours maximum\*\*

\$120 5-day prepaid package (must be purchased on the day of Temperament Test evaluation only)

\$260 10-day prepaid package

\$500 20-day prepaid package

Packages must be used within 3 months from date of purchase.

\*\* Temperament Test Required

\*\*\* If a guest does not attend daycare for two months or more, or at staff discretion, we will require them to be re-temperament tested for the safety of all guests in our care.

## OVERNIGHT STAYS FOR FELINE GUESTS

\$22 (1) cat \$40 (2) cats \$55 (3) cats

## OVERNIGHT STAYS FOR OUR POCKET PET GUESTS

\$12 ea.- Hamster, Bunny, Ferret, Turtle, please call for other pet type

## PROOF OF CURRENT VACCINATIONS IS REQUIRED

### CANINE BOARDING AND GROOMING

- Canine DHPP (1 or 3 year) + Leptospirosis (1 year), or DHLPP (1 or 3 year) which includes Lepto. (1 year)
- Canine Rabies 1- or 3-year
- Canine Bordetella 6-months or 1-year  
(Updated at least 10 days before your pet's stay)
- Negative fecal test within the year including screen for parasites (Giardia and Coccidia)
- The canine influenza shot is not needed at this time (subject to change)
- Dog Grooming - No fecal test is an option, a \$5 fee will be added

### FELINE BOARDING

- Feline FVRCP
- Feline Rabies 1- or 3-year
- Negative fecal test within the year including screen for parasites (Giardia and Coccidia)

Vaccinations must have been administered by a veterinary clinic.

We do not accept self administered vaccines or those administered by third-parties who are not veterinarians. Titers will be accepted with documentation.



## CHARGES FOR ADDITIONAL SERVICES PROVIDED:

### BOARDING DOG GROUP PLAY FEE

\$5.00 Per dog

### FOOD ADDITIVES Per Serving:

\$0.50 Pumpkin

\$0.50 Chicken & beef broth

\$0.50 Parmesan Cheese

### PROBIOTICS Per Serving:

\$1.50 Lodge Provided

### MEDICATION ADMINISTRATION

Per Each Dosage Administered:

\$1.50 Owner Oral Med.

\$1.50 Owner Topical Med.

### PREMIUM FOOD PREPERATION

\$1.50 Per Meal:

Multiple food types exceeding (2) items.  
The prep. of food requiring cutting, chopping or the peeling of eggs.

### LODGE PROVIDED FOOD

Per Serving:

\$3.00 Wet canned (Dog/Cat)

\$3.00 Dry food (Dog/Cat)

### LODGE PROCUREMENT OF PET GUEST SPECIFIC FOOD

\$20.00 Trip charge +

Mileage @ \$0.65 per mile

### LODGE TRANSPORT TO A VETERINARY OFFICE VISIT

\$50.00 Trip charge +

Mileage @ \$0.65 per mile

Service costs are per Pet Guest.

EMAIL [hello@thelodgeforpamperedpets.com](mailto:hello@thelodgeforpamperedpets.com)

WEBSITE [www.thelodgeforpamperedpets.com](http://www.thelodgeforpamperedpets.com)

3397 S LAPEER RD | PO BOX 158

METAMORA MI 48455

(810) 77LODGE or (810) 775-6343